

**GMC**  
WE ARE PROFESSIONAL GRADE

ALL-NEW 2018  
**TERRAIN**





# MIGHTY LIKE A PRO

Mighty defeats size. It conquers the odds. Mighty is how pros perform. The all-new 2018 Terrain is the compact SUV reimagined with you in mind. Expressive design, relentless engineering and purposeful technologies are the latest reminders that the same passion and purpose that drive you also drive us. We're setting our own standards and proving that Professional Grade isn't merely a label, it's a way of life. Terrain is the newest example that we're all pros. We take a bold, mighty stance for what we believe in and pursue it like a pro.



TERRAIN SLT IN QUICKSILVER METALLIC  
shown with available equipment.



TERRAIN DENALI IN GRAPHITE GRAY METALLIC  
shown with available equipment.

Preproduction models shown throughout. Actual production models may vary.





DESIGN

**| ENTICE  
LIKE A PRO**

CREATING DESIRE UPON FIRST GLANCE IS OUR TRADEMARK. SO, TOO, IS AN UNMISTAKABLE CONFIDENCE THAT HINTS AT THE ENGINEERING EXCELLENCE WITHIN THE 2018 TERRAIN.

# INSPIRATION

To create an interior you'd feel comfortable in, we drew inspiration from the worlds of aviation, architecture, furniture and even wristwatches. Their resistance to the typical and the ordinary helped us create an interior refined around you.

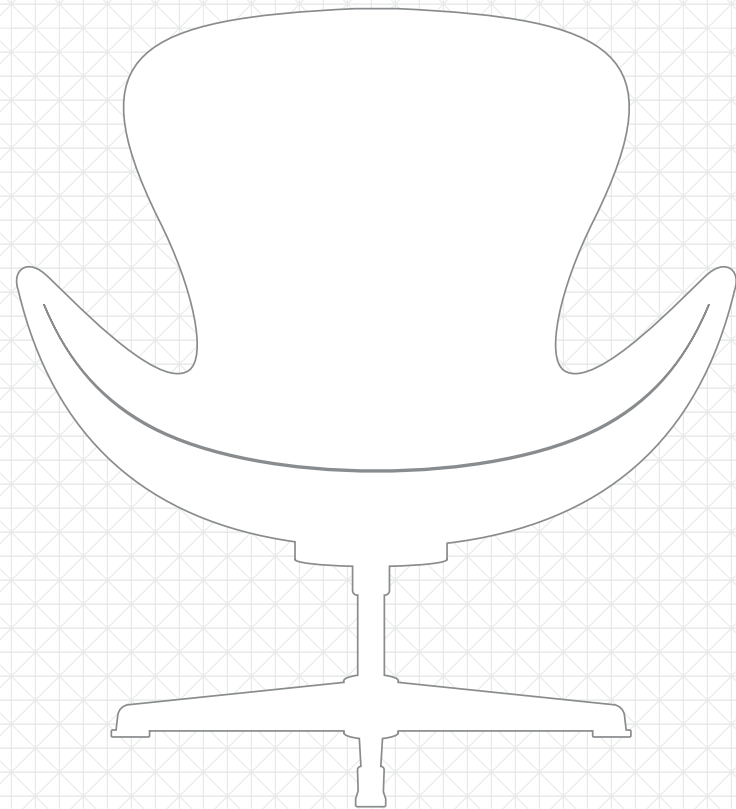

**FURNITURE** We were heavily influenced by modern furniture. To be specific, we drew inspiration from mid-century modern designs. The idea that shapes serve a purpose, nothing is frivolous or ostentatious. The placement of premium materials provides a sense of quality and attention to detail. The use of contrasting stitching and the feel of a soft-touch instrument panel give the sense the interior was designed just for you.

**WATCHES** We looked at high-end watches. Watches that projected a sense of quality and precision rather than decadence. For example, we wanted Terrain's gauges and infotainment screen to be high-tech and intuitive. The gauge cluster has a clean and easy-to-read design. Everything from the infotainment system to the latest technologies were intelligently engineered into the interior.



**ARCHITECTURE** Terrain's cabin was influenced by architects such as Eero Saarinen and others. They used materials in unique, innovative ways, creating modern and bold new looks. Our design team adopted the same philosophy to make the interior bold, modern, structural and an extension of your home. So it needs to feel just as inviting.

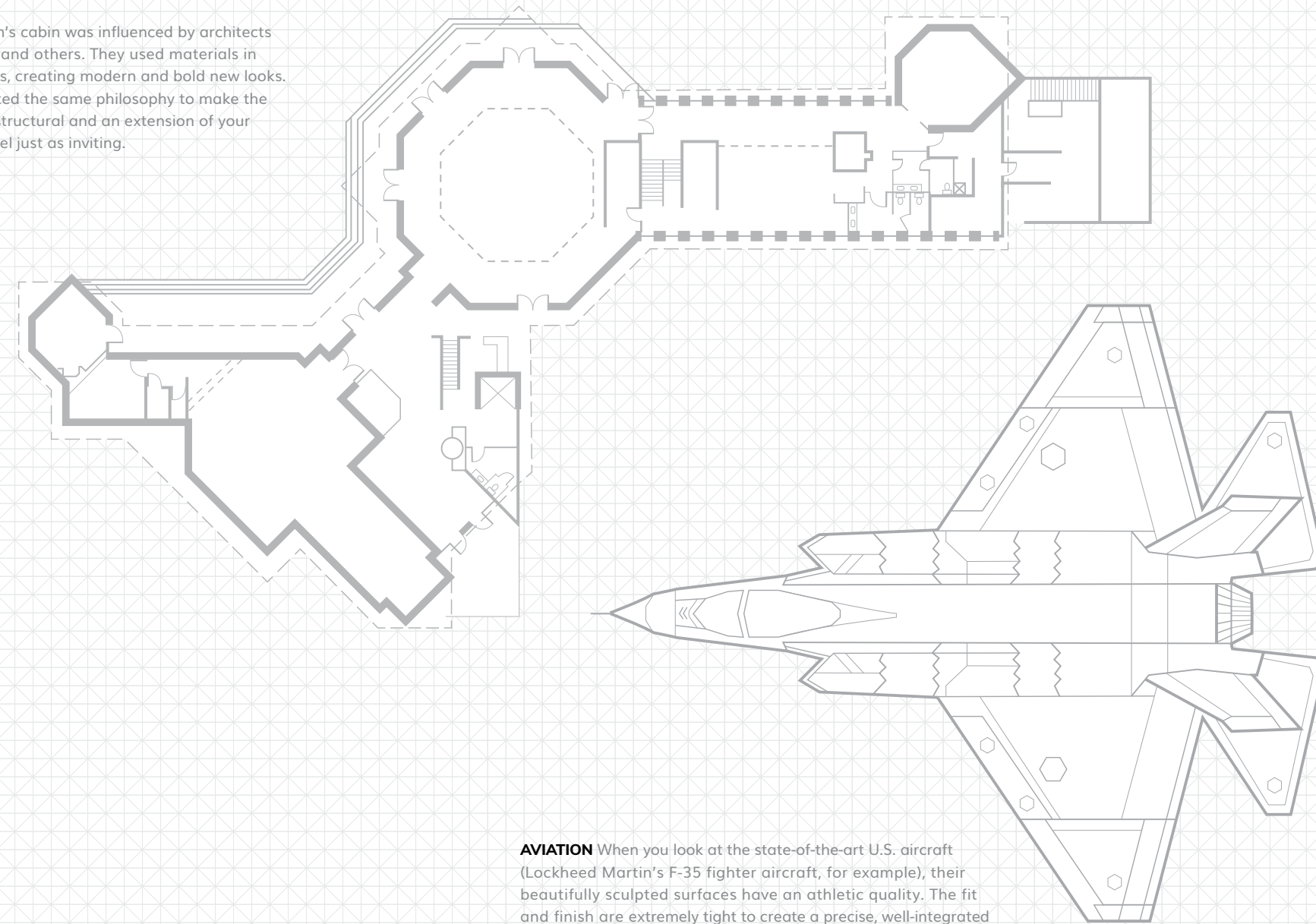

**AVIATION** When you look at the state-of-the-art U.S. aircraft (Lockheed Martin's F-35 fighter aircraft, for example), their beautifully sculpted surfaces have an athletic quality. The fit and finish are extremely tight to create a precise, well-integrated appearance. These elements were brought into our design, giving Terrain's interior a sculpted look and feel.





TERRAIN DENALI INTERIOR IN TAUPE/LIGHT PLATINUM shown with available equipment.

## A DESIGN THAT DOESN'T STOP AT THE DOOR

There's a design harmony flowing between Terrain's exterior and interior to create a sense of consistency, spaciousness and symmetry. You'll find a blend of contemporary styling, premium soft-touch materials and authentic aluminum trim throughout the cabin. From your first entry, Terrain elevates the experience.



A wide-angle photograph of the front interior of a Cadillac Denali SUV. The seats are upholstered in a light-colored, textured material, likely leather or leatherette, with a quilted pattern on the backrests. The dashboard, center console, and door panels are finished in a matching light color with dark wood trim accents. The steering wheel is leather-wrapped with the Cadillac logo in the center. The instrument cluster and infotainment screen are visible on the right side of the dashboard. The overall lighting is soft and even, highlighting the textures and materials of the interior.

**EASY TO ENTER.  
HARD TO LEAVE.**

TERRAIN DENALI INTERIOR IN TAUPE/LIGHT PLATINUM  
shown with available equipment.



**SPEAKS VOLUMES.  
SILENTLY.**



TERRAIN SLT IN BLUE STEEL METALLIC  
shown with available equipment.



THE ART  
OF TERRAIN

We've elevated Terrain's design to a major art form. It's bold and confident. Distinctive features—such as C-shaped LED signature lighting surrounding the headlamps and taillamps, exclusive Denali grille and sculpted wheels—perfectly integrate beauty and purpose to catch your eye while optimizing functionality.





**IT MOVES.  
STANDING STILL.**

TERRAIN DENALI IN GRAPHITE GRAY METALLIC  
shown with available equipment.

ENGINEERING



2.0L I-4 Turbo

## OVERACHIEVE LIKE A PRO

FROM THE BEGINNING, WE'VE RELENTLESSLY PUSHED THE BOUNDS OF PHYSICS,  
SCIENCE AND MATHEMATICS TO NOT SIMPLY RAISE THE BAR, BUT COMPLETELY REINVENT IT.





TERRAIN DENALI IN GRAPHITE GRAY METALLIC  
shown with available equipment.

**YOUR DRIVE.  
TURBOCHARGED.**



# CHOOSE YOUR POWER

No matter how you drive, Terrain's turbocharged engines generate their own performance personality to match your needs. The 1.5L offers efficiency without sacrifice; the 1.6L offers diesel low-end torque and efficiency; and the 2.0L produces strong acceleration and pulling power (3,500 lbs<sup>1</sup> max trailering capacity). Transferring all of this performance to the road are all-new 9-speed automatic transmissions on the 1.5L and 2.0L gas-engine models and a 6-speed automatic transmission on the 1.6L Turbo Diesel. In fact, Terrain is the only vehicle in its class to offer a standard turbocharged engine combined with a 9-speed transmission.

## 1.5L 170-HP I-4 TURBO<sup>2</sup>

Standard SL/SLE/SLT



## 1.6L 240 LB-FT OF TORQUE I-4 TURBO DIESEL<sup>2</sup>

Available SLE/SLT



## 2.0L 252-HP I-4 TURBO

Standard Denali; Available SLE/SLT



<sup>1</sup>Before you buy a vehicle or use it for trailering, carefully review the trailering section of the Owner's Manual. The weight of passengers, cargo and options or accessories may reduce the amount you can tow. <sup>2</sup>Available late summer 2017.



# TENACITY

## TRACTION: IT'S NAMED TERRAIN FOR A REASON

We expect you to challenge Terrain with a variety of driving environments, surfaces and conditions. The Traction Select system is engineered to allow you to make real-time adjustments to how Terrain responds based on those ever-changing driving situations. Front-Wheel-Drive (FWD) models feature Normal, Snow and available Tow/Haul modes, while available All-Wheel-Drive (AWD) models offer Off-Road, available Tow/Haul and an AWD Disconnect mode engineered to optimize efficiency.

TRACTION SELECT SYSTEM



ELECTRIC VARIABLE POWER-ASSIST STEERING

ALL-WHEEL-DRIVE SYSTEM (AVAILABLE)

19" WHEELS WITH ALL-SEASON TIRES (AVAILABLE)

CORROSION-RESISTANT DURALIFE BRAKE ROTORS







## HERE'S SOMETHING YOU DON'T HEAR EVERY DAY: QUIET

In a world filled with noise, Terrain fills the cabin with quiet. We've helped reduce unwanted engine noise with Active Noise Cancellation in every 2018 Terrain. This technology identifies and reduces undesirable sounds by constantly monitoring and measuring engine noise. Terrain works to cancel out unwanted engine sound while preserving those sounds you want to hear. In addition, Terrain features an acoustically laminated windshield to help minimize wind and other outside noise while driving.

TERRAIN DENALI INTERIOR IN JET BLACK  
shown with available equipment.





FUNCTIONALITY

## **PERFORM LIKE A PRO**

EVERY ELEMENT IN TERRAIN GOES BEYOND ITS BOLD, CONFIDENT APPEARANCE. EACH ONE SERVES A HEIGHTENED PURPOSE—GIVING A WHOLE NEW MEANING TO THE UTILITY IN SUV.



## WE ENCOURAGE CARRY-ONS

Terrain includes many storage solutions. For 2018, we replaced the traditional center console-mounted transmission shifter with a class-exclusive push-button and pull-switch-based Electronic Precision Shift System. This creates an expansive lighted under-console pass-through storage area along with side-by-side cupholders. There's also plenty of storage in the center console with an organizing system, upper and lower door panels and a compartment built into the passenger-side instrument panel. We've also carved out plenty of under-floor storage in the cargo area.







## AN EIGHT-FOOT LADDER? THERE'S ROOM FOR THAT, TOO.

We designed Terrain to handle the varied demands of your life. It quickly goes from comfortably accommodating people to easily allowing you to use every inch of space for cargo. A front-to-back flat load floor includes new fold-flat front-passenger and 60/40 split folding second-row seats so you can carry long objects (up to 8 feet) with ease. When folded down, the hard material on the back of the front seat helps protect it from damage. With the front-passenger seat folded down, you have up to 81 cubic feet of max cargo space.<sup>1</sup> To access all of this space, Terrain offers an available hands-free power liftgate.

<sup>1</sup>Cargo and load capacity limited by weight and distribution.

TERRAIN SLT INTERIOR IN JET BLACK/BRANDY  
shown with available equipment.



## SETTLE IN. NEVER SETTLE.

Have a seat, but not just any seat. A major focus in designing the 2018 Terrain was seat comfort—no matter which row you choose. On Denali models, in addition to available heated and ventilated front seats, we offer available rear outboard heated seats. Plus, rear-seat passengers get to personalize their comfort with two seatback positions. The driver seat offers available eight-way power adjustments with two-way lumbar, and there is an available six-way front-passenger seat.

TERRAIN DENALI INTERIOR IN TAUPE/LIGHT PLATINUM  
shown with available equipment.

Terrain achieves the ultimate in support and comfort with seats engineered to maintain their shape from day one to the long road ahead.





# PROACTIVE

## HELPS KEEP TROUBLE FROM FINDING YOU

To increase awareness of surrounding traffic, Terrain offers available intuitive driver-assist and safety technologies. They help you avoid collisions by pointing out potential threats. And like a pro, no other competitor in its class offers a GM-exclusive Safety Alert Driver Seat.



Safety features are no substitute for the driver's responsibility to operate the vehicle in a safe manner. The driver should remain attentive to traffic, surroundings and road conditions at all times. Read the vehicle Owner's Manual for important feature limitations and information.



## OUR LATEST INNOVATION: EASY TO USE

Terrain's infotainment system is familiar and easy to use. Smartphone integration projects your phone's screen and select apps onto Terrain's 7" or available 8" diagonal center screen—allowing you hands-free access to texts, NAV with available real-time traffic updates,<sup>1</sup> music and more. And to truly make listening a pleasure, choose the available Bose® premium seven-speaker sound system.

### AVAILABLE 8" DIAGONAL CENTER MULTI-TOUCH SCREEN INCLUDES:

- + APPLE CARPLAY™ COMPATIBILITY<sup>2</sup>
- + ANDROID AUTO™ COMPATIBILITY<sup>2</sup>
- + BLUETOOTH<sup>3</sup> FOR PHONE AND AUDIO STREAMING
- + ADVANCED VOICE RECOGNITION
- + 4G WI-FI® HOTSPOT\* (AVAILABLE)
- + NAVIGATION<sup>5</sup> (AVAILABLE)

<sup>1</sup>Requires trial or subscription. <sup>2</sup>Vehicle user interfaces are products of Apple® and Google™ and their terms and privacy statements apply. Requires compatible smartphone. Data plan rates apply. <sup>3</sup>Go to mygmc.com/learn to find out which phones are compatible with the vehicle. <sup>4</sup>Requires a compatible mobile device, active service and data plan. 4G service available in select markets. Visit onstar.com for coverage map, details and system limitations. Data plan provided by AT&T.® <sup>5</sup>Map coverage available in the United States, Puerto Rico and Canada.



## DEFINE YOUR TERRAIN

Add your own exclamation point to the 2018 Terrain. GMC Accessories are designed so you can personalize your Terrain to fit your style as well as your needs. These accessories are also engineered and tested to meet your standards.



**CARGO PACKAGE** Enhance the functionality of your cargo area with the Cargo Package. It includes a custom-molded, integrated cargo liner in Jet Black with red GMC logo that covers both the cargo-area floor and the back of the rear seat, providing enhanced protection when carrying items of various sizes. To keep items secure, the cargo net with integrated storage pouch prevents small items placed inside it from shifting while in transit. Conceal your possessions with the retractable cargo security shade, which mounts behind the rear seat and extends rearward above the cargo area when in use.



**ROOF-MOUNTED CARRIER** Conveniently and safely transport your bicycle with the versatile roof-mounted Sidearm Bike Carrier by Thule®. Accommodates disc brakes, thru-axles and other non-traditional frame styles, and offers maximum frame protection, making contact with only the wheel.



**ROOF RACK CROSS RAILS** Add function and style to your vehicle with the Roof Rack Cross Rail Package. These cross rails are removable and are the base for mounting other cargo-management accessories.



**FLOOR LINERS** Get maximum protection for the interior of your vehicle with premium all-weather floor liners. Specifically designed for your vehicle, they provide precise coverage around the interior trim, driver pedals, seat tracks and door jambs for substantial carpet coverage.



**ALL-WEATHER FLOOR MATS** Help protect the floor of your vehicle with the hardworking functionality of these premium all-weather floor mats. Featuring the GMC logo on the front mats, these precision-designed mats fit the floor of your vehicle exactly, and nubs on the back help keep them in place. The custom pattern collects rain, mud, snow and other debris for easy cleaning.



**PREMIUM CARPET MATS** Enhance the appearance of your vehicle while helping to protect the carpet from rain, mud, snow and other debris with premium carpeted floor mats, available in Jet Black with two different color bindings, to complement your vehicle's interior.



**ASSIST STEPS** Get in and out of your vehicle with ease with these stylish molded assist steps, featuring a textured pattern for more sure footing and the GMC logo in the center of the step.



**NON-POWERED TABLET HOLDER** Second-row passengers can easily use their tablets on the road with the universal tablet holder. It securely holds a single tablet against the front seatback in a choice of portrait or landscape orientations, attaching to the driver- or front-passenger-seat head restraint posts.



**ACCENTS**

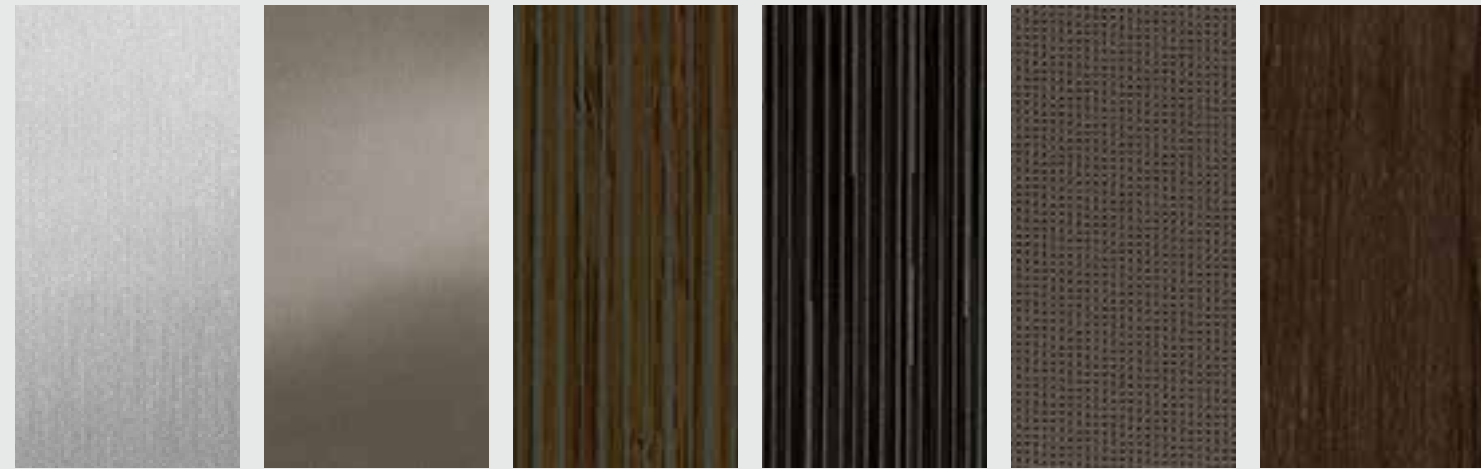

Axiom Aluminum    Burnish Aluminum    Timberline    Luxury Brown    Tech Twill    Siberian Elm Wood Tone

**INTERIOR COLORS AND SEATING SURFACES**

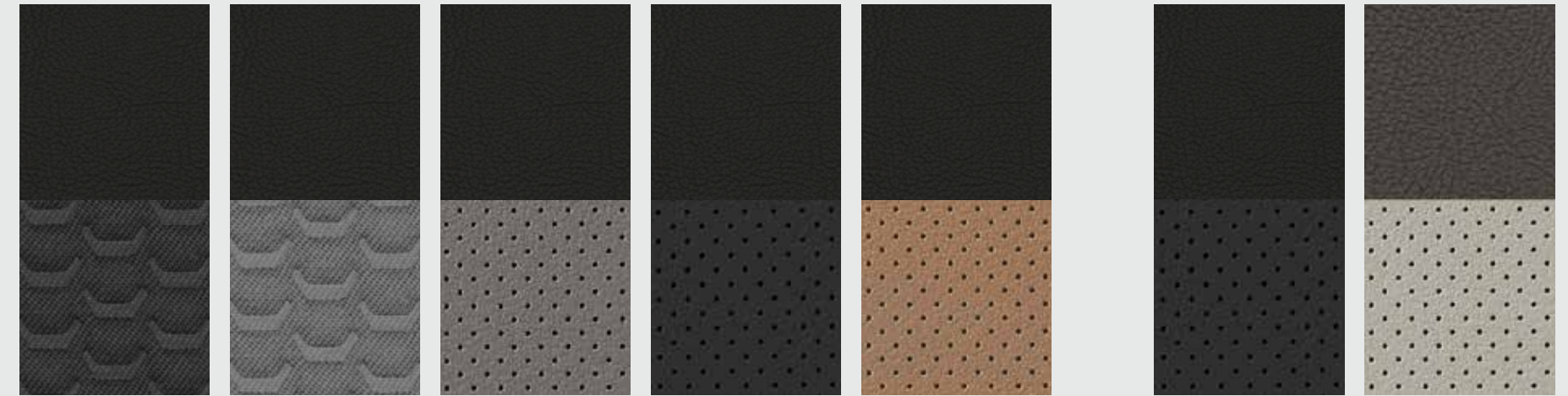

Jet Black/Jet Black Premium Cloth    Jet Black/Medium Ash Gray Premium Cloth    Jet Black/Medium Ash Gray Perforated Leather-Appointed    Jet Black/Jet Black Perforated Leather-Appointed    Jet Black/Brandy Perforated Leather-Appointed    Jet Black/Jet Black Perforated Leather-Appointed with Embroidered Denali Logo    Taupes/Light Platinum Perforated Leather-Appointed with Embroidered Denali Logo

**MODELS**

<b>DENALI</b>	—	●	—	—	—	●
<b>SLT AND SLT DIESEL</b>	●	—	—	●	● <sup>1</sup>	—
<b>SLE AND SLE DIESEL</b>	●	—	●	—	—	—
<b>SL</b>	●	—	●	—	—	—

KEY ● STANDARD — NOT AVAILABLE

**EXTERIOR COLORS** See your dealer for more availability details.

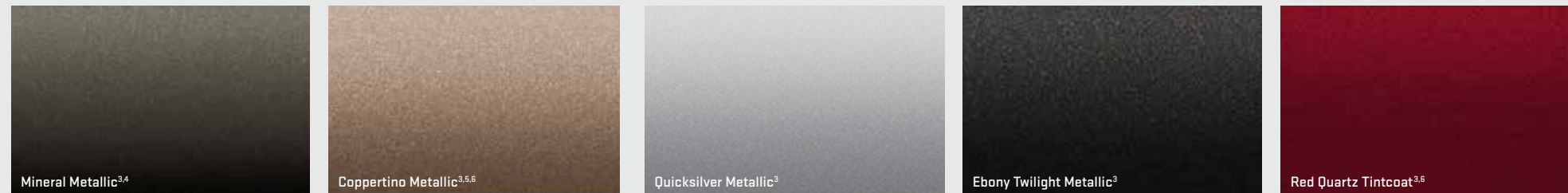

Mineral Metallic<sup>3,4</sup>    Coppertino Metallic<sup>3,5,6</sup>    Quicksilver Metallic<sup>3</sup>    Ebony Twilight Metallic<sup>3</sup>    Red Quartz Tintcoat<sup>3,6</sup>

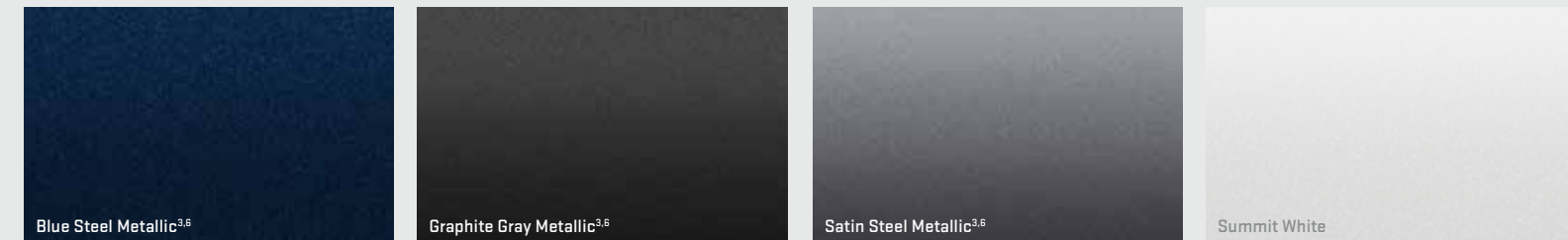

Blue Steel Metallic<sup>3,6</sup>    Graphite Gray Metallic<sup>3,6</sup>    Satin Steel Metallic<sup>3,6</sup>    Summit White

<sup>1</sup>Included with Jet Black/Brandy interior color combination only. <sup>2</sup>Includes unique Shale piping accents. <sup>3</sup>Extra-cost color. <sup>4</sup>Denali only. <sup>5</sup>Not available on Denali. <sup>6</sup>Not available on SL.



# WHEELS WORTHY OF TERRAIN

Building a Professional Grade SUV such as the 2018 Terrain means engineering every inch of it from the ground up—including its wheels. You'll find a selection of specially designed GMC wheels in a range of styles. Your dealer can provide more wheel availability details.

19" ULTRA-BRIGHT MACHINED ALUMINUM (RT7) WITH PREMIUM GRAY PAINTED ACCENTS STANDARD ON DENALI



19" MACHINED ALUMINUM WITH GRAY PAINTED ACCENTS (PJH) AVAILABLE ON SLT. INCLUDED WHEN THE (LTG) 2.0L TURBO 4-CYLINDER ENGINE IS ORDERED.



18" MACHINED ALUMINUM WITH DARK GRAY PAINTED ACCENTS (RV6) STANDARD ON SLT AND SLT DIESEL



18" ALUMINUM SILVER PAINTED (RSX) AVAILABLE ON SLE. INCLUDED WHEN THE (LTG) 2.0L TURBO 4-CYLINDER ENGINE IS ORDERED.



17" ALUMINUM SILVER PAINTED (RSB) STANDARD ON SL, SLE AND SLE DIESEL

## TERRAIN SPECIFICATIONS

TRIM LEVELS

### MECHANICAL

	SL	SLE	SLE DIESEL	SLT	SLT DIESEL	DENALI
<b>DISC BRAKES</b> 4-wheel antilock, 4-wheel disc with Duralife rotors	●	●	●	●	●	●
<b>DRIVETRAIN</b> Front-Wheel Drive	●	●	●	●	●	●
Driver-selectable on-demand All-Wheel-Drive system	-	○	○	○	○	○
<b>TRACTION SELECT SYSTEM</b>	●	●	●	●	●	●
<b>ENGINE</b> 1.5L Turbocharged DOHC 4-cylinder, VVT with Stop/Start technology. Available late summer 2017. See your dealer for more availability details.	●	●	-	●	-	-
2.0L Turbocharged DOHC 4-cylinder, VVT with Stop/Start technology	-	○	-	○	-	●
1.6L Turbocharged Diesel DOHC 4-cylinder with Stop/Start technology. Available late summer 2017. See your dealer for more availability details.	-	-	●	-	●	-
<b>ENGINE BLOCK HEATER</b>	○	○	-	○	-	○
<b>OIL PAN HEATER</b>	-	-	○	-	○	-
<b>ENGINE OIL LIFE MONITOR</b>	●	●	●	●	●	●
<b>EXHAUST</b> Single outlet	●	●	●	●	●	-
Dual outlets with bright tips. On SLE and SLT trim, included and only available with 2.0L Turbo 4-cylinder engine.	-	○	-	○	-	●
<b>STABILITRAK</b> Stability control system and traction control	●	●	●	●	●	●
<b>STEERING</b> Power with electric assist	●	●	●	●	●	●
<b>SUSPENSION</b> MacPherson strut front and 4-link rear independent	●	●	●	●	●	●
Enhanced ride and handling with uniquely tuned suspension valving and urethane spring isolators	-	-	-	-	-	●
<b>HILL DESCENT CONTROL</b>	●	●	●	●	●	●
<b>TRAILERING EQUIPMENT<sup>1</sup></b> Includes factory-installed Class II trailer hitch, 1.25" receiver hitch and 4-wire connection. On SLE trim, requires the Driver Convenience Package and 2.0L Turbo 4-cylinder engine. On SLT trim, requires the Preferred Package and 2.0L Turbo 4-cylinder engine.	-	○	-	○	-	○
<b>TRANSMISSIONS</b> 9-speed automatic, electronically controlled	●	●	-	●	-	●
6-speed automatic, electronically controlled	-	-	●	-	●	-
Electronic Precision Shift, button-and-switch-based transmission interface	●	●	●	●	●	●

### SEATING

<b>SEAT TRIM</b> Premium Cloth, stain resistant	●	●	●	-	-	-
Perforated leather-appointed seating	-	-	-	●	●	-
Perforated leather-appointed seating with unique Denali piping and embroidered Denali logo on front-seat head restraints	-	-	-	-	-	●
<b>SEATS</b> 4-way driver manual, fore/aft, up/down with recline	●	●	-	-	-	-
8-way power driver with 2-way power lumbar. On SLE trim, included and only available with the Driver Convenience Package.	-	○	●	●	●	●
4-way front-passenger manual, fore/aft, up/down with recline	●	●	●	-	-	-
6-way power front-passenger with 2-way power lumbar. On SLT trim, included and only available with the Preferred Package.	-	-	-	○	●	●
2-position memory for driver seat and outside rearview mirrors. On SLT trim, included and only available with the Preferred Package.	-	-	-	○	●	●
Heated front seats. On SLE trim, included and only available with the Driver Convenience Package.	-	○	●	●	●	●
Ventilated front seats. Included and only available with the Comfort Package.	-	-	-	-	-	○
Heated rear outboard seating positions. Included and only available with the Comfort Package.	-	-	-	-	-	○
60/40 split-folding rear seat with center armrest and recline	●	●	●	●	●	●
Fold-flat passenger-side front seatback	●	●	●	●	●	●
Second-row seat mechanical release levers in cargo area	-	●	●	●	●	●
5-passenger seating (2-3 configuration)	●	●	●	●	●	●

KEY ● STANDARD ○ AVAILABLE - NOT AVAILABLE

TRIM LEVELS

### INSTRUMENTATION AND CONTROLS

	SL	SLE	SLE DIESEL	SLT	SLT DIESEL	DENALI
<b>ELECTRONIC CRUISE CONTROL</b>	●	●	●	●	●	●
<b>DRIVER INFORMATION CENTER</b> 3.5" monochromatic	●	●	●	-	-	-
4.2" multicolor enhanced driver information screen. On SLE and SLE Diesel trims, included and only available with the Infotainment Package I.	-	○	○	●	●	●
<b>KEYLESS OPEN AND START</b>	●	●	●	●	●	●
<b>DIGITAL COMPASS DISPLAY</b>	-	●	●	●	●	●
<b>REAR-SEAT REMINDER<sup>2</sup></b>	●	●	●	●	●	●
<b>STEERING WHEEL</b> Leather-wrapped with audio and cruise controls	●	●	●	●	●	●
Heated leather-wrapped with audio and cruise controls. On SLT trim, included and only available with the Preferred Package.	-	-	-	○	●	●
<b>TEEN DRIVER TECHNOLOGY</b> A configurable feature that lets you activate customizable vehicle settings associated with a key fob, to encourage safe driving behavior. It can limit certain vehicle features, and it prevents certain safety systems from being turned off. An in-vehicle report gives you information on your teen's driving habits and helps you to continue to coach your new driver.	●	●	●	●	●	●

### INTERIOR DETAILS

<b>ACTIVE NOISE CANCELLATION</b> Engine noise control system	●	●	●	●	●	●
<b>ASSIST HANDLES</b> Front and rear outboard	●	●	●	●	●	●
<b>CARGO STORAGE</b> Under cargo-area floor	●	●	●	●	●	●
<b>CLIMATE CONTROL</b> Single-zone, manual	●	●	-	-	-	-
Automatic, dual-zone with individual climate settings for driver and front passenger. On SLE trim, included and only available with the Driver Convenience Package.	-	○	●	●	●	●
Rear climate vents	●	●	●	●	●	●
<b>CONSOLE</b> Front center console with storage	●	●	●	●	●	●
<b>DEFOGGER</b> Rear-window electric	●	●	●	●	●	●
<b>FLOOR MATS</b> Carpeted front and rear. On SL trim, includes front row only.	●	●	●	●	●	-
Premium, Denali-specific	-	-	-	-	-	●
<b>LIGHTING</b> Interior with theater dimming, reading lights for front seats, second-row reading lamps, cargo compartment and illuminated entry and exit feature	●	●	●	●	●	●
Interior with accent lighting under door armrest, floor console and instrument panel	-	-	-	●	●	●
<b>MIRRORS</b> Inside rearview, manual	●	-	-	-	-	-
Inside rearview, auto-dimming	-	-	-	●	●	●
<b>POWER DOOR LOCKS</b> Programmable with lockout protection and rear child security	●	●	●	●	●	●
<b>POWER OUTLET</b> 3-prong, 110-volt, household-style. Located on the rear of center console. On SLE and SLE Diesel trim, included and only available with the Infotainment Package I.	-	○	○	●	●	●
12-volt, 1 front auxiliary and 1 cargo-area auxiliary	●	●	●	●	●	●
<b>POWER WINDOWS</b> With driver express-up and -down, passenger express-down and rear express-down	●	●	●	●	●	●
<b>REMOTE KEYLESS ENTRY</b> Passive entry and extended range	●	●	●	●	●	●
<b>REMOTE VEHICLE START</b> On SLE trim, included and only available with the Driver Convenience Package	-	○	●	●	●	●
<b>SILL PLATES</b> Front, Denali-specific	-	-	-	-	-	●
<b>SUNGLASS STORAGE</b> Overhead	●	●	●	●	●	●
<b>SUNROOF</b> SkyScape. Tilt-sliding, front and fixed rear with power sunshade. On SLE trim, requires the Driver Convenience Package. On SLE Diesel trim, requires the Driver Alert Package I and the Infotainment Package I. On SLT trim, requires the Preferred Package. On SLT Diesel trim, requires the Driver Alert Package I, the Driver Alert Package II and the Infotainment Package II.	-	○	○	○	○	○
<b>UNIVERSAL HOME REMOTE</b> 3-channel programmable. Includes garage-door opener. On SLT trim, included and only available with the Preferred Package.	-	-	-	○	●	●
<b>WIRELESS CHARGING FOR DEVICES<sup>3</sup></b> Located in front of center console storage bin. Included and only available with the Comfort Package.	-	-	-	-	-	○

<sup>1</sup>Before you buy a vehicle or use it for trailering, carefully review the trailering section of the Owner's Manual. The weight of passengers, cargo and options or accessories may reduce the amount you can tow. <sup>2</sup>Does not detect people or items. Always check the rear seat before exiting the vehicle. <sup>3</sup>The system wirelessly charges one PMA- or Qi-compatible mobile device. Some devices require an adapter or back cover. To check for phone or other device capability, visit my.gmc.com/learn for details.



TRIM LEVELS

**OPTION PACKAGES**

	SL	SLE	SLE DIESEL	SLT	SLT DIESEL	DENALI
<b>DRIVER CONVENIENCE PACKAGE</b> Includes remote vehicle start, dual-zone automatic climate control, driver and front-passenger heated seats, 8-way power driver-seat adjuster, driver power lumbar and roof rails	-	○	●	-	-	-
<b>INFOTAINMENT PACKAGE I</b> Includes 8" diagonal GMC Infotainment System <sup>1</sup> with Navigation <sup>2</sup> and AM/FM/SiriusXM Satellite Radio <sup>3</sup> for 3 months, 4.2" multicolor enhanced driver information screen, 2 USB ports <sup>4</sup> located within the center console, SD memory card reader and 110-volt power outlet. On SLE trim, requires the Driver Convenience Package.	-	○	○	-	-	-
<b>INFOTAINMENT PACKAGE II</b> Includes 8" diagonal GMC Infotainment System <sup>1</sup> with Navigation, <sup>2</sup> Bose <sup>®</sup> premium 7-speaker system, amplifier and HD Radio. On SLT trim, requires the Preferred Package. On SLT Diesel trim, requires the Driver Alert Package I.	-	-	-	○	○	-
<b>DRIVER ALERT PACKAGE I</b> Includes Lane Change Alert with Side Blind Zone Alert, Rear Cross Traffic Alert, Rear Park Assist and Safety Alert Driver Seat. Also includes outside heated power-adjustable manual-folding body-color mirrors with LED turn-signal indicators. On SLE trim, requires the Driver Convenience Package. On SLE Diesel trim, requires the Infotainment Package I and SkyScape panoramic power sunroof. On SLT trim, requires the Preferred Package. On SLT Diesel trim, requires the Infotainment Package II.	-	○	○	○	○	●
<b>DRIVER ALERT PACKAGE II</b> Includes Low Speed Forward Automatic Braking, Forward Collision Alert, Lane Keep Assist with Lane Departure Warning, Following Distance Indicator and IntelliBeam headlamps. On SLT trim, requires the Preferred Package and Driver Alert Package I. On SLT Diesel trim, requires the Driver Alert Package I, Infotainment Package II and SkyScape panoramic power sunroof.	-	-	-	○	○	○
<b>PREFERRED PACKAGE</b> Includes hands-free power programmable liftgate, Memory Package, front-passenger 6-way power seat with power lumbar, heated steering wheel and Universal Home Remote	-	-	○	●	●	●
<b>MEMORY PACKAGE</b> Includes 2 memory settings for the driver seat and outside rearview mirrors. On SLT trim, included and only available with the Preferred Package.	-	-	-	○	●	●
<b>COMFORT PACKAGE</b> Includes ventilated driver and front-passenger seat, heated rear outboard seating positions and wireless charging <sup>5</sup> for devices	-	-	-	-	-	○
<b>ADVANCED SAFETY PACKAGE</b> Includes Automatic Parking Assist and Surround Vision. Requires the Driver Alert Package II.	-	-	-	-	-	○
<b>ENTERTAINMENT/COMMUNICATION/NAVIGATION</b>						
<b>7" DIAGONAL GMC INFOTAINMENT SYSTEM<sup>1</sup></b> Includes multi-touch display, AM/FM stereo, Bluetooth <sup>®6</sup> streaming audio for music and most phones and Apple CarPlay™ and Android Auto™ capability <sup>7</sup> for compatible phones	●	●	●	-	-	-
<b>8" DIAGONAL GMC INFOTAINMENT SYSTEM<sup>1</sup></b> Includes multi-touch display, AM/FM/SiriusXM <sup>3</sup> (standard for 3 months), Bluetooth <sup>®6</sup> streaming audio for music and most phones, Apple CarPlay™ and Android Auto capability <sup>7</sup> for compatible phones, personalized profiles for infotainment and vehicle settings, in-vehicle apps and advanced voice recognition for radio and phone	-	-	-	●	●	-
<b>8" DIAGONAL GMC INFOTAINMENT SYSTEM<sup>1</sup> WITH NAVIGATION<sup>2</sup></b> Includes multi-touch display, AM/FM/SiriusXM <sup>3</sup> (standard for 3 months), Bluetooth <sup>®6</sup> streaming audio for music and most phones, Apple CarPlay™ and Android Auto capability <sup>7</sup> for compatible phones, personalized profiles for infotainment and vehicle settings, in-vehicle apps and advanced voice recognition for radio and phone. On SLE and SLE Diesel trims, included and only available with the Infotainment Package I. On SLT and SLT Diesel trims, included and only available with the Infotainment Package II.	-	○	○	○	○	-
<b>8" DIAGONAL GMC INFOTAINMENT SYSTEM<sup>1</sup> WITH NAVIGATION<sup>2</sup></b> Includes multi-touch display, AM/FM/SiriusXM <sup>3</sup> (standard for 3 months), Bluetooth <sup>®6</sup> streaming audio for music and most phones, Apple CarPlay™ and Android Auto capability <sup>7</sup> for compatible phones, personalized profiles for infotainment and vehicle settings, in-vehicle apps and advanced voice recognition for radio and phone. Includes increased memory.	-	-	-	-	-	●
<b>SIRIUSXM SATELLITE RADIO<sup>3</sup></b> Including 3 trial months of service. On SLE and SLE Diesel trims, included and only available with the Infotainment Package I.	-	○	○	●	●	●
<b>CONNECTED NAVIGATION SERVICE<sup>8</sup></b> Relevant navigation features are now connected to the cloud to provide real-time information such as up-to-date points of interest, traffic updates, fuel prices, parking information, route calculations and more. Requires service plan. Includes limited trial. Included and only available with 8" diagonal GMC Infotainment System <sup>1</sup> with Navigation. <sup>2</sup>	-	○	○	○	○	●
<b>HD RADIO</b> On SLT and SLT Diesel trims, included and only available with the Infotainment Package II	-	-	-	○	○	●
<b>AUDIO</b> 6-speaker system	●	●	●	●	●	-
7-speaker Bose premium sound system with amplifier. On SLT and SLT Diesel trims, included and only available with the Infotainment Package II.	-	-	-	○	○	●
<b>BLUETOOTH<sup>®6</sup></b> For phone, personal cell phone connectivity to vehicle audio system	●	●	●	●	●	●
<b>USB DATA PORTS<sup>4</sup></b> Includes 1 type-A and 1 type-C located within front center storage bin. Also includes auxiliary input jack.	●	●	●	●	●	●
2, type-A, located within the center console. On SLE and SLE Diesel trims, included and only available with the Infotainment Package I.	-	○	○	●	●	●
2 rear charge-only. <sup>4</sup> Located on rear of the center console.	●	●	●	●	●	●

KEY ● STANDARD ○ AVAILABLE - NOT AVAILABLE

**SD MEMORY CARD READER** Located within front center storage bin. On SLE and SLE Diesel trims, included and only available with the Infotainment Package I.

**4G<sup>®</sup> WI-FI HOTSPOT CAPABILITY** See your dealer for more details

**EXTERIOR STYLING AND FUNCTIONALITY**

	SL	SLE	SLE DIESEL	SLT	SLT DIESEL	DENALI
<b>GLASS</b> Deep tinted except windshield and driver- and front-passenger-side glass	●	●	●	●	●	●
Acoustic, laminated windshield	●	●	●	●	●	●
<b>GRILLE</b> Chrome surround	●	●	●	-	-	-
Chrome surround and accents	-	-	-	●	●	-
Signature Denali	-	-	-	-	-	●
Shutters, active aero	●	●	●	●	●	●
<b>LIGHTS</b> High-Intensity Discharge headlamps with LED signature lighting	●	●	●	●	●	-
LED headlamps with LED signature lighting	-	-	-	-	-	●
Front halogen projector fog lamps	-	-	-	●	●	●
Taillamps with LED signature lighting	●	●	●	●	●	●
<b>TRIM</b> Black lower bodyside	●	●	●	●	●	-
Denali-specific, body-color lower with chrome insert	-	-	-	-	-	●
<b>OUTSIDE MIRRORS</b> Heated, power-adjustable, manual-folding	●	●	●	-	-	-
Heated, power-adjustable, manual-folding with LED turn-signal indicators. Included and only available with the Driver Alert Package I.	-	○	○	-	-	-
Heated, power-adjustable, manual-folding, driver-side auto-dimming and LED turn-signal indicators. Includes driver memory feature on SLT Diesel and Denali trims.	-	-	-	●	●	●
<b>OUTSIDE MIRROR CAPS</b> Black	●	-	-	-	-	-
Body-color	-	●	●	●	●	-
Chrome	-	-	-	-	-	●
<b>LIFTGATE</b> Manual	●	●	●	-	-	-
Power, programmable. On SLE trim, requires the Driver Convenience Package.	-	○	●	-	-	-
Power, programmable, hands-free. On SLT trim, included and only available with the Preferred Package.	-	-	-	○	●	●
<b>WIPERS</b> Front and rear intermittent with washers	●	●	●	●	●	●
<b>ROOF RAILS</b> Black painted. On SLE trim, included and only available with the Driver Convenience Package.	-	○	○	-	-	-
Silver painted	-	-	-	●	●	-
Bright, Denali-specific	-	-	-	-	-	●
Cross rails, dealer-installed. On SLE trim, requires the Driver Convenience Package. Required when 2.0L turbocharged engine is ordered on SLT AWD model.	-	○	○	○	○	○

**SAFETY AND SECURITY**

<b>AIR BAGS<sup>10</sup></b> Includes dual-stage frontal, thorax/pelvis side-impact for driver and front passenger and front and rear head-curtain side-impact for outboard seating positions. Includes Passenger Sensing System.	●	●	●	●	●	●
<b>REAR VISION CAMERA SYSTEM</b> With dynamic grid lines	●	●	●	●	●	●
<b>TIRE PRESSURE MONITORING SYSTEM</b> Manual learn with Tire Fill Alert. Does not monitor spare tire.	●	●	●	●	●	●
<b>VEHICLE THEFT-DETERRENT SYSTEM</b>	●	●	●	●	●	●
<b>LANE CHANGE ALERT WITH SIDE BLIND ZONE ALERT</b> Included and only available with the Driver Alert Package I	-	○	○	○	○	●
<b>REAR CROSS TRAFFIC ALERT</b> Included and only available with the Driver Alert Package I	-	○	○	○	○	●
<b>REAR PARK ASSIST</b> Included and only available with the Driver Alert Package I	-	○	○	○	○	●
<b>SAFETY ALERT DRIVER SEAT</b> Included and only available with the Driver Alert Package I	-	○	○	○	○	●
<b>LOW SPEED FORWARD AUTOMATIC BRAKING</b> Included and only available with the Driver Alert Package II	-	-	-	○	○	○
<b>FORWARD COLLISION ALERT</b> Included and only available with the Driver Alert Package II	-	-	-	○	○	○
<b>LANE KEEP ASSIST WITH LANE DEPARTURE WARNING</b> Included and only available with the Driver Alert Package II	-	-	-	○	○	○
<b>FOLLOWING DISTANCE INDICATOR</b> Included and only available with the Driver Alert Package II	-	-	-	○	○	○
<b>INTELLIBEAM HEADLAMPS</b> Included and only available with the Driver Alert Package II	-	-	-	○	○	○
<b>SURROUND VISION</b> Includes bird's-eye view of front, side and rear-vision cameras. Included and only available with the Advanced Safety Package.	-	-	-	-	-	○
<b>AUTOMATIC PARKING ASSIST</b> Includes front, rear, parallel and perpendicular park assist. Included and only available with the Advanced Safety Package.	-	-	-	-	-	○

**STANDARD TECHNICAL DATA**

<b>1.5L TURBOCHARGED VVT I-4 ENGINE</b> With Stop/Start technology	
Horsepower @ rpm	170 @ 5,600
Torque @ rpm (lb-ft)	203 @ 2,000-4,000
Valvetrain	DOHC, 4 valves per cylinder with continuously Variable Valve Timing (VVT)
Fuel delivery	High-pressure direct fuel injection and electronic throttle control
<b>2.0L TURBOCHARGED VVT I-4 ENGINE</b> With Stop/Start technology	
Horsepower @ rpm	252 @ 5,500
Torque @ rpm (lb-ft)	260 @ 2,500-4,500
Valvetrain	DOHC, 4 valves per cylinder with continuously Variable Valve Timing (VVT)
Fuel delivery	High-pressure direct fuel injection and electronic throttle control
<b>1.6L TURBOCHARGED DIESEL I-4 ENGINE</b> With Stop/Start technology	
Horsepower @ rpm	137 @ 3,750
Torque @ rpm (lb-ft)	240 @ 2,000
Valvetrain	DOHC, 4 valves per cylinder
Fuel delivery	Common-rail fuel injection
<b>TRANSMISSIONS</b>	
1.5L I-4	9T45 9-speed automatic
2.0L I-4	9T50 9-speed automatic
1.6L I-4 Diesel	6T45 6-speed automatic
<b>STANDARD FRONT-WHEEL DRIVE (FWD)</b>	
<b>AVAILABLE ALL-WHEEL DRIVE (AWD)</b>	Driver selectable
<b>BRAKES</b>	
	4-wheel disc with antilock braking system and Duralife rotors
<b>STEERING</b>	
	Electric variable-effort rack-and-pinion system
<b>BATTERY</b>	
	Maintenance-free with rundown protection
<b>FUEL TANK CAPACITY (FWD/AWD)</b>	
	14.9 gallons/15.6 gallons (approx.)
<b>DIESEL EXHAUST FLUID (DEF) TANK CAPACITY</b>	
	4.9 gallons (approx.)
<b>MAX TRAILERING WEIGHT<sup>11</sup> (lb)</b> (1.5L I-4/1.6L Diesel I-4/2.0L I-4)	
	1,500/1,500/3,500
<b>TURNING DIAMETER</b> (curb-to-curb) (ft.) (17" wheels/18" wheels/19" wheels)	
	37.4/38.4/41.6
<b>EXTERIOR DIMENSIONS</b> (in.)	
Overall Height	65.4 without roof rails (does not include shark fin antenna)
Overall Width	72.4
Overall Length	182.3
Wheelbase	107.3
Track (in.) (Front/Rear)	62.3/62.5
<b>INTERIOR DIMENSIONS</b> (in.) (front/second row)	
Head Room	40.0/38.5 (without sunroof)/38.2/36.8 (with sunroof)
Leg Room	40.9/39.7
Shoulder Room	57.2/55.6
Hip Room	54.4/51.8
<b>MAX CARGO-AREA CAPACITIES</b> (cu. ft.) <sup>12</sup>	
All seats folded (includes front-passenger seat and 60/40 split-folding rear seat)	81.0
Behind first row	63.3
Behind second row	29.6

<sup>1</sup>Full functionality requires compatible Bluetooth and smartphone. Some devices require USB connectivity. Data plan rates apply. <sup>2</sup>Map coverage available in the United States, Puerto Rico and Canada. <sup>3</sup>If you decide to continue service after your trial, the subscription plan you choose will automatically renew thereafter and you will be charged according to your chosen payment method at then-current rates. Fees and taxes apply. To cancel, you must call SiriusXM at 1-866-635-2349. See SiriusXM Customer Agreement for complete terms at siriusxm.com. All fees and programming subject to change. For more information about NavTraffic, visit siriusxm.com/navtraffic. For more information about Travel Link, visit siriusxm.com/travellink. Sirius, XM, SiriusXM and all related marks and logos are trademarks of SiriusXM Radio, Inc. <sup>4</sup>Not compatible with all devices. <sup>5</sup>The system wirelessly charges one PMA- or Qi-compatible mobile device. Some devices require an adapter or back cover. To check for phone or other device capability, visit my.gmc.com/learn for details. <sup>6</sup>Go to my.gmc.com/learn to find out which phones are compatible with the vehicle. <sup>7</sup>Vehicle user interfaces are products of Apple<sup>®</sup> and Google<sup>™</sup> and their terms and privacy statements apply. Requires compatible smartphone. Data plan rates apply. <sup>8</sup>Requires trial or subscription. <sup>9</sup>Requires a compatible mobile device, active service and data plan. 4G service available in select markets. Visit onstar.com for coverage map, details and system limitations. Data plan provided by AT&T. <sup>10</sup>A NOTE ON CHILD SAFETY: Always use safety belts and the correct child restraint for your child's age and size, even with air bags. Even in vehicles equipped with the Passenger Sensing System, children are safer when properly secured in a rear seat in the appropriate infant, child or booster seat. Never place a rear-facing infant restraint in the front seat of any vehicle equipped with an active frontal air bag. See your vehicle Owner's Manual and child safety seat instructions for more safety information. <sup>11</sup>Before you buy a vehicle or use it for trailering, carefully review the trailering section of the Owner's Manual. The weight of passengers, cargo and options or accessories may reduce the amount you can tow. <sup>12</sup>Cargo and load capacity limited by weight and distribution.



## PEACE OF MIND

Pro Grade Protection is standard on every 2018 Terrain. From maintenance to protecting your entire vehicle, you can drive with confidence.

INCLUDES 2 MAINTENANCE VISITS DURING THE FIRST 2 YEARS/24,000 MILES<sup>1</sup>

3-YEAR/36,000-MILE BUMPER-TO-BUMPER LIMITED WARRANTY<sup>2</sup>

5-YEAR/60,000-MILE POWERTRAIN LIMITED WARRANTY<sup>2</sup>

5-YEAR/60,000-MILE ROADSIDE ASSISTANCE/COURTESY TRANSPORTATION<sup>2</sup>

<sup>1</sup>Maintenance visits must occur within 2 years or 24,000 miles of vehicle delivery, whichever comes first. Does not include air filters. See participating dealer for other restrictions and complete details. <sup>2</sup>Whichever comes first. See dealer for limited-warranty details.



## WE'RE AS CLOSE AS THE BLUE BUTTON

Connect to a specially trained Emergency Medical Dispatch-certified<sup>1</sup> Advisor just by pushing the blue OnStar button in your Terrain.

**EMERGENCY: HELP WHEN IT MATTERS MOST.** OnStar protects you and your passengers in the event of an emergency with the right help, right when you need it.

**AUTOMATIC CRASH RESPONSE.<sup>2</sup>** Using built-in sensors, Automatic Crash Response can connect you to an OnStar Advisor immediately after a crash to help get you the care you need even if you can't ask for it. Using Injury Severity Prediction technology, professionally trained Advisors can notify first responders about the likelihood of serious injury so they can provide the right help, right away. You can feel confident knowing you have a team, 24/7, to get you the assistance you need.

**ROADSIDE ASSISTANCE.<sup>3</sup>** If you've got a flat tire or are low on gas, just push the blue OnStar button, and an Advisor will get things moving with Roadside Assistance. We can use GPS technology to pinpoint where you are and send a tow truck or whatever help you need. No matter how far you are from home, you're empowered with solutions that keep you moving.

**CRISIS ASSIST.** During severe weather or a crisis, OnStar can provide critical guidance during your time of need. With Crisis Assist,<sup>2</sup> our Advisors provide a fast, knowledgeable resource for emergency assistance, special routing assistance and other services. We're a 24-hour connection and central point of contact for help when you need it most.

**SECURITY: PROTECTION YOU CAN COUNT ON.** Breathe easy knowing a comprehensive suite of Stolen Vehicle Assistance services is available to help protect your vehicle.

**STOLEN VEHICLE ASSISTANCE.<sup>4</sup>** If your vehicle is stolen, you can be assured OnStar Advisors are ready to take action. Once you report your vehicle stolen, they can pinpoint its location, work with the police to quickly recover it, slow the vehicle if the conditions are safe to do so and even prevent it from restarting. And with Theft Alarm Notification,<sup>5</sup> if your vehicle alarm sounds, we'll let you know via text, email and/or a phone call. One simple call puts a team into action to help recover your vehicle quickly and safely.

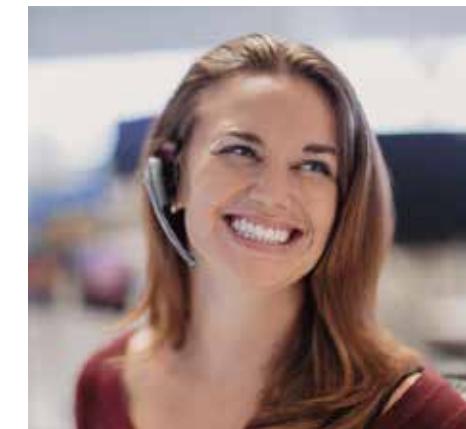

<sup>1</sup>Visit [onstar.com](http://onstar.com) for coverage map, details and system limitations. Some services require paid OnStar service plan. OnStar Advisors are certified by the International Academies of Emergency Dispatch. <sup>2</sup>Visit [onstar.com](http://onstar.com) for vehicle availability, details and system limitations. OnStar acts as a link to existing emergency service providers. Not all vehicles may transmit all crash data. <sup>3</sup>Roadside service provided by Allstate Roadside Services. <sup>4</sup>Services are subject to user terms and limitations and vary by vehicle model. Requires subscription to Security Plan, Guidance Plan or Safety & Security Plan. These services are intended to assist with vehicle recovery and do not prevent theft or protect against damage or loss. Visit [onstar.com](http://onstar.com) for more details. <sup>5</sup>Services are subject to user terms and other limitations and vary by vehicle model. Requires armed GM factory-installed theft-deterrent system; subscription to Security Plan, Guidance Plan or Safety & Security Plan; and selection of notification communication preference(s). Additional messaging and data rates may apply. Visit [onstar.com](http://onstar.com) for more details.



## CONVERSATION STARTER

At GMC, we don't want you to merely follow us on social media. We'd like to start a dialogue

so we can learn more about each other. Join the conversation and share your passion for

all things Professional Grade. [gmc.com](http://gmc.com) | [#gmcterrain](https://twitter.com/gmcterrain)



### IMPORTANT WORDS

#### PRO GRADE PROTECTION

For 2018, Terrain comes with the Pro Grade Protection Plan, which includes two maintenance visits,<sup>1</sup> 3-year/36,000-mile Bumper-to-Bumper Limited Warranty<sup>2</sup> and 5-year/60,000-mile Powertrain Limited Warranty,<sup>2</sup> Roadside Assistance and Courtesy Transportation.

Starting with the owner orientation—and full tank of gas—you receive when you take possession of your Terrain, to the 24-Hour Roadside Assistance, Courtesy Transportation and Travel Benefits, you receive a portfolio of owner privileges that lasts throughout your warranty. For expert product information, Roadside Assistance or other services, call 1-800-GMC-8782.

**TRAVEL BENEFITS AND ROADSIDE ASSISTANCE** Available around the clock: trip routing service, a program for reimbursement for trip interruption due to necessary warranty repairs, towing, flat tire change, jump-starts and more for 5 years or 60,000 miles (whichever comes first).

**COURTESY TRANSPORTATION** Available at participating dealers: shuttle service, reimbursement of certain public transportation or fuel expenses for overnight warranty repairs and courtesy rental for overnight work repairs. See your dealer for details.

**GMC OWNER CENTER** A complimentary, one-stop resource to enhance your GMC ownership experience. It's easy to sign up. Just go to [gm.com/gmownercenter/gmc](http://gm.com/gmownercenter/gmc).

#### ONSTAR AND GMC CONNECTED SERVICES

 Connected vehicle services require a paid connected vehicle services plan or trial, connected hardware, vehicle electrical system (including battery), wireless service and GPS satellite signal to be available and operating for features to function properly. OnStar acts as a link to existing emergency service providers. Visit [onstar.com](http://onstar.com) for coverage map, details and system limitations.

#### SIRIUSXM SATELLITE RADIO

 SiriusXM Satellite Radio<sup>3</sup> is standard on select Terrain models. It includes 3 trial months of service. SiriusXM Satellite Radio makes your drive come alive with commercial-free music channels from virtually every genre, artist-dedicated channels, live performances and more. Tune in to live play-by-play from the biggest sports, exclusive entertainment from top personalities, compelling talk, hilarious comedy, world-class news, local traffic and weather and family-friendly programming. Welcome to the world of satellite radio. Visit [siriusxm.com](http://siriusxm.com) for details.

#### GMC CERTIFIED SERVICE

 To help your Terrain live up to its performance promise, GMC Certified Service—found exclusively at your GMC dealer—is there. With all the engineering excellence in Terrain, GM-trained technicians have the expertise to care for all of it.

#### ADDITIONAL NOTES

**A NOTE ON CHILD SAFETY** Always use safety belts and the correct child restraint for your child's age and size, even with air bags. Even in vehicles equipped with the Passenger Sensing System, children are safer when properly secured in a rear seat in the appropriate infant, child or booster seat. Never place a rear-facing infant restraint in the front seat of any vehicle equipped with an active frontal air bag. See your vehicle Owner's Manual and child safety seat instructions for more safety information.

**TRAILERING AND OFF-ROAD INFORMATION** Please carefully review the Owner's Manual for important safety information about trailering or off-road driving in your vehicle.

**FLEET ORDERS** Some standard content may be deleted with fleet orders. See dealer for details.

**ENGINES** GMC products are equipped with engines produced by GM Powertrain or other suppliers to GM worldwide. The engines in GMC products may also be used in other GM makes and models.

**GMC.COM** See more of Terrain on our website: [gmc.com/terrain](http://gmc.com/terrain). More photos and information; hot links to related subjects; convenient dealer locator; pricing guide, spec out your own vehicle. Or call 1-800-GMC-8782.

#### BUYPOWER CARD™



Now it's even easier to get into the GMC of your dreams. Every purchase gives you Earnings redeemable toward part or even all of a new GMC, Chevrolet, Buick or Cadillac. Every year, enjoy 5 percent Earnings on your first \$5,000 in purchases and 2 percent unlimited Earnings after that. No expiration on Earnings and no limit on how much you can earn or redeem. Learn more at [buypowercard.com/catalog](http://buypowercard.com/catalog). YOUR CARD IS THE KEY.™

**IMPORTANT WORDS ABOUT THIS CATALOG** We have tried to make this catalog comprehensive and factual. We reserve the right, however, to make changes at any time, without notice, in prices, colors, materials, equipment, specifications, models and availability. Specifications, dimensions, measurements, ratings and other numbers in this catalog and other printed materials provided at the dealership or affixed to vehicles are approximates based upon design and engineering drawings and prototypes and laboratory tests. Your vehicle may differ due to variations in manufacture and equipment. Since some information may have been updated since the time of printing, please check with your GMC dealer for complete details. GMC reserves the right to lengthen or shorten the model year for any product for any reason, or to start and end model years at different times. All competitive claims are based on the latest information available at the time of printing and GM Compact SUV segment.

**AN IMPORTANT NOTE ABOUT ALTERATIONS AND WARRANTIES** Installations or alterations to the original equipment vehicle (or chassis) as distributed by General Motors are not covered by the General Motors New-Vehicle Limited Warranty. The special body company, assembler, equipment installer or upfitter is solely responsible for warranties on the body or equipment and any alterations (or any effect of the alterations) to any of the parts, components, systems or assemblies installed by GM. General Motors is not responsible for the safety or quality of design features, materials or workmanship of any alterations by such suppliers.

**NEW-VEHICLE LIMITED WARRANTY** All GMC Terrain models come with a fully transferable, no-deductible 5-year/60,000-mile (whichever comes first) Powertrain Limited Warranty. GM vehicles registered in the USA are also covered for 3 years or 36,000 miles (whichever comes first). Coverage includes tires and towing to your nearest GMC dealership. Repairs will be made to correct any vehicle defect and most warranty repairs will be made at no charge. In addition, rust-through corrosion will be covered for 6 years or 100,000 miles (whichever comes first). Terrain also comes with two maintenance visits within the first 2 years/24,000 miles (whichever comes first).<sup>1</sup> See dealer for details.

**ASSEMBLY** GMC vehicles and their components are assembled or produced by different operating units of General Motors, its subsidiaries or suppliers to GM worldwide. We sometimes find it necessary to produce GMC vehicles with different or differently sourced components than originally scheduled. Since some options may be unavailable when your vehicle is assembled, we suggest that you verify that your vehicle includes the equipment you ordered or, if there are changes, that they are acceptable to you.

**GMMOBILITY.COM** (1-800-323-9935) GM Mobility offers financial assistance for eligible adaptive equipment to make automotive travel easier for persons with disabilities or special transportation needs. To learn more about special GM Mobility offers, visit [gmmobility.com](http://gmmobility.com).

<sup>1</sup>Maintenance visits must occur within 2 years or 24,000 miles of vehicle delivery, whichever comes first. Does not include air filters. See participating dealer for other restrictions and complete details. <sup>2</sup>Whichever comes first. See dealer for limited-warranty details. <sup>3</sup>If you decide to continue service after your trial, the subscription plan you choose will automatically renew thereafter and you will be charged according to your chosen payment method at then-current rates. Fees and taxes apply. To cancel, you must call SiriusXM at 1-866-635-2349. See SiriusXM Customer Agreement for complete terms at [siriusxm.com](http://siriusxm.com). All fees and programming subject to change. For more information about NavTraffic, visit [siriusxm.com/navtraffic](http://siriusxm.com/navtraffic). For more information about Travel Link, visit [siriusxm.com/travelink](http://siriusxm.com/travelink). Sirius, XM, SiriusXM and all related marks and logos are trademarks of SiriusXM Radio, Inc.

©2017 General Motors. All rights reserved. GM, the GM logo, GMC, the slogans, emblems, vehicle model names, vehicle body designs and other marks appearing in this catalog are the trademarks and/or service marks of General Motors, its subsidiaries, affiliates or licensors. Facebook is a registered trademark of Facebook, Inc. Twitter is a registered trademark of Twitter, Inc. YouTube is a registered trademark of Google Inc. Instagram is a registered trademark of Instagram, LLC. Android Auto is a trademark of Google Inc. Sirius, XM and all related marks and logos are trademarks of SiriusXM Radio, Inc. Apple and CarPlay are registered trademarks of Apple, Inc. F-35 and Lockheed Martin are registered trademarks of Lockheed Martin Corporation and GMC has no affiliation or relationship with, or is sponsored by, Lockheed Martin Corporation in connection with this advertising and GMC's Terrain vehicle.

VISIT US AT GMC.COM